

Welcome to North Devon District Hospital

Northern Devon Healthcare **NHS** NHS Trust

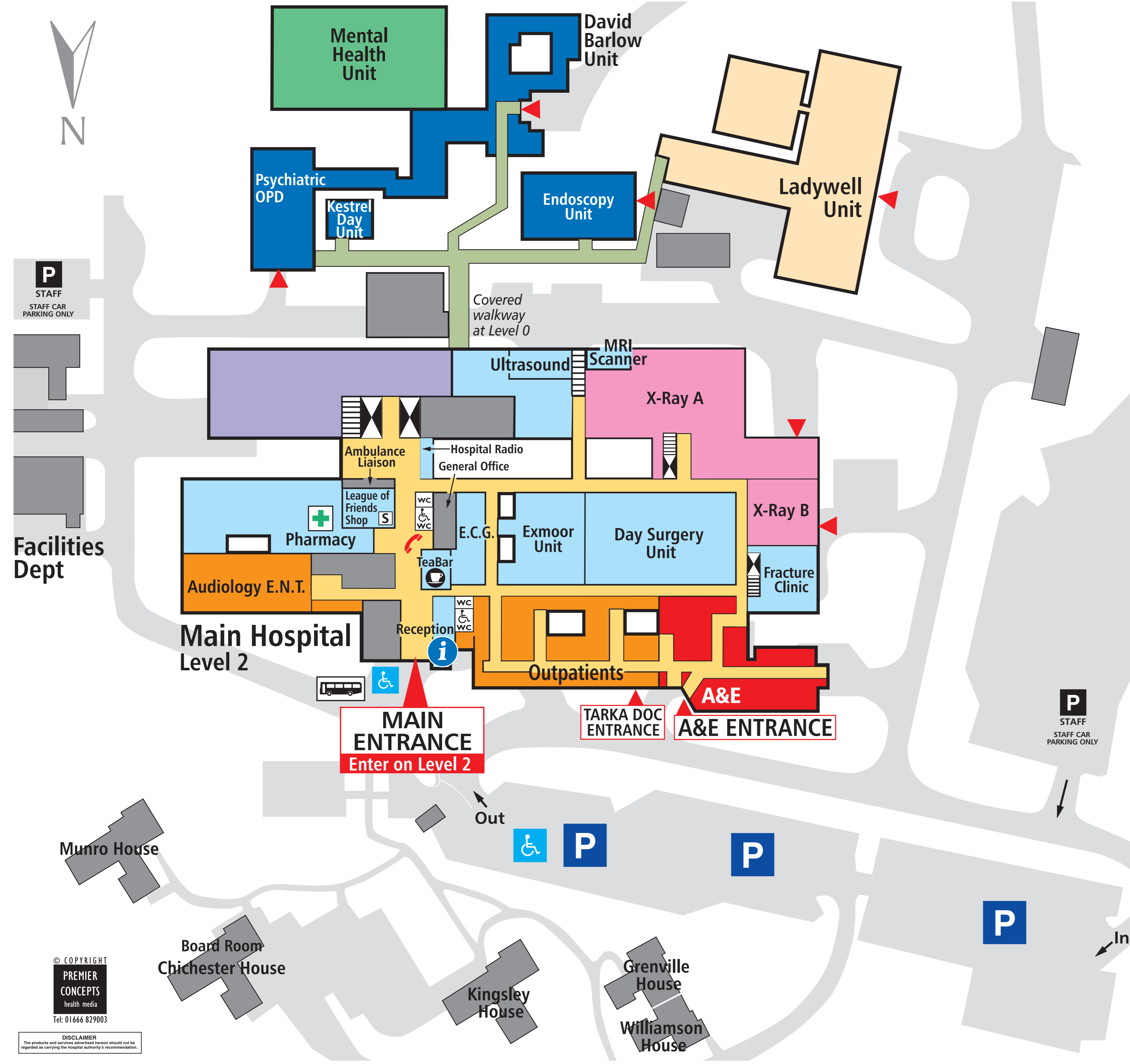

DEPARTMENT	LEVEL	DEPARTMENT	LEVEL
Main Hospital			
Accident & Emergency	2	Lundy Ward	3
Alexandra Ward	1	Macmillan Suite (Alex)	1
Ambulance Liaison	2	Main Entrance	2
Audiology ENT	2	Main Theatre Suite	3
Budd Ward	1	Medical Education Centre	1
Capener Ward	3	Mortuary	0
Caroline Thorpe Ward	3	MRI Scanner	2
Chapel	1	Occupational Therapy	1
Chemotherapy Unit	4	Orthodontic/Maxillofacial Dept	1
Colorectal & Stoma Care Unit	4	Orthopaedic Outpatients	1
Coronary Care Unit	4	Outpatients (General)	2
Day Surgery Unit	2	Paediatric Outpatients	3
ECG	2	Pathology	1
EEG Department	1	Pharmacy	2
Exmoor Unit	2	Physiotherapy	1
Eye Department	2	Reception	2
Fortescue FAU/MAU	4	Restaurant (Raleigh Galley)	0
Fracture Clinic	2	Roborough Suite	3
General Office	2	Shop (League of Friends)	2
Glossop Ward	5	Speech Therapy	1
Hospital Radio (Tarka Radio)	2	Staples Ward	5
Hydrotherapy	1	Tarka Doc	2
Intensive Care Unit	3	Tea Bar (League of Friends)	2
King George V Ward	4	Trinity	5
Library	1	X-Ray Departments (A&B)	2

DEPARTMENT	LEVEL	DEPARTMENT	LEVEL
Ladywell Unit			
Ante-Natal	0	David Barlow & Linked Units	
Bassett Ward	1	David Barlow Unit	0
Breast Care Unit	2	Endoscopy	0
Delivery Unit	0	Kestrel Day Unit	0
Gynaecology	0	Mental Health Unit	0
Petter Ward	2	Psychiatric Outpatients & Occupational Therapy	0
Psychology	0		
Special Care Baby Unit (SCBU)	0		

- INFORMATION
- LIFTS
- RESTAURANT
- CAR PARKING FOR PATIENTS & VISITORS
- LINK CORRIDORS
- STAIRS
- TEA / COFFEE
- DISABLED CAR PARKING
- ENTRANCES
- WC MALE & FEMALE
- SHOP
- COVERED WALKWAY
- PUBLIC TELEPHONE
- DISABLED WC
- PHARMACY
- BUS STOP

© COPYRIGHT PREMIER CONCEPTS health media
Tel: 01666 829003

DISCLAIMER
The products and services advertised herein should not be regarded as carrying the hospital authority's recommendation.

Welcome to

North Devon District Hospital

Northern Devon Healthcare **NHS**
NHS Trust

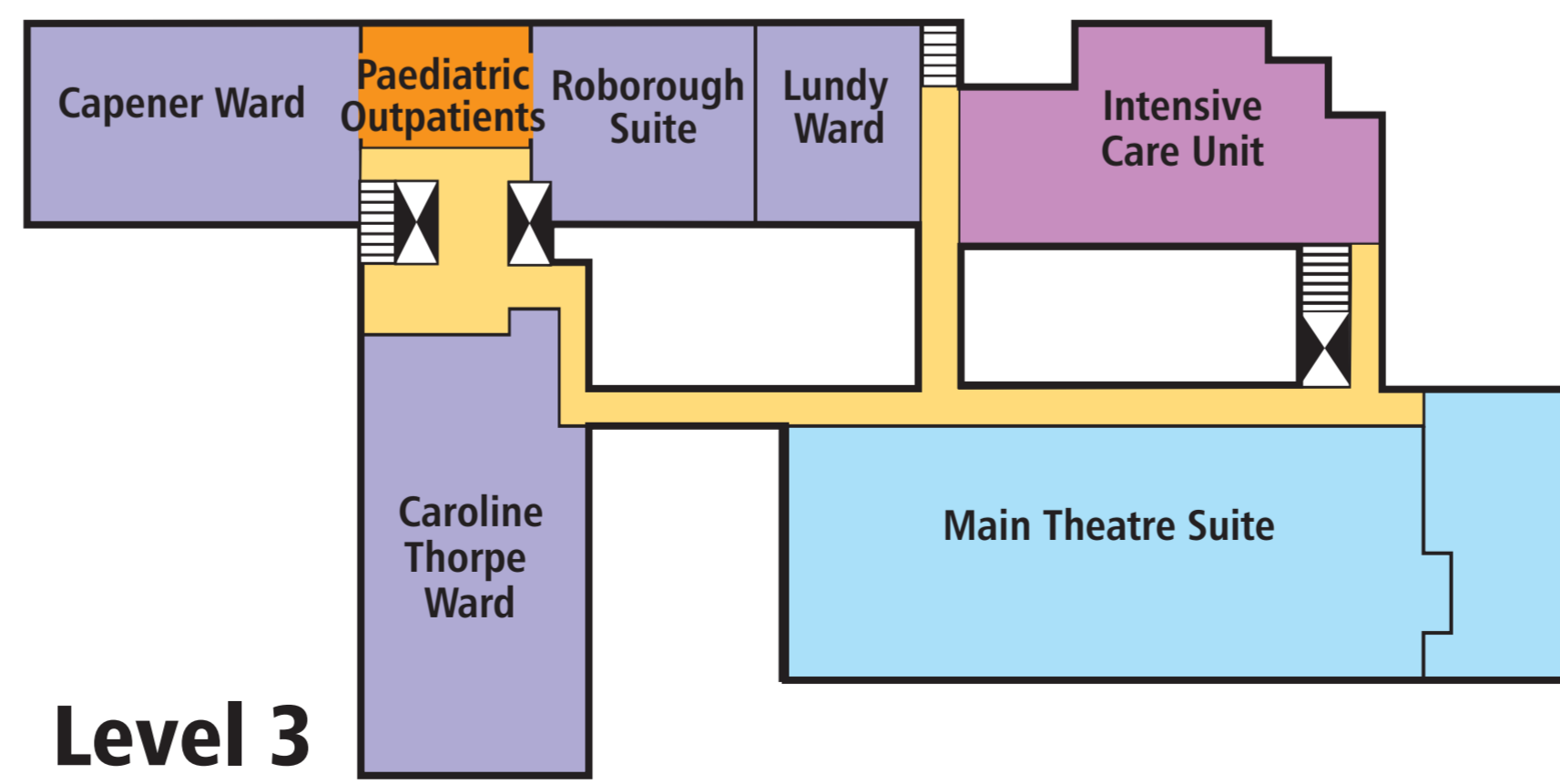
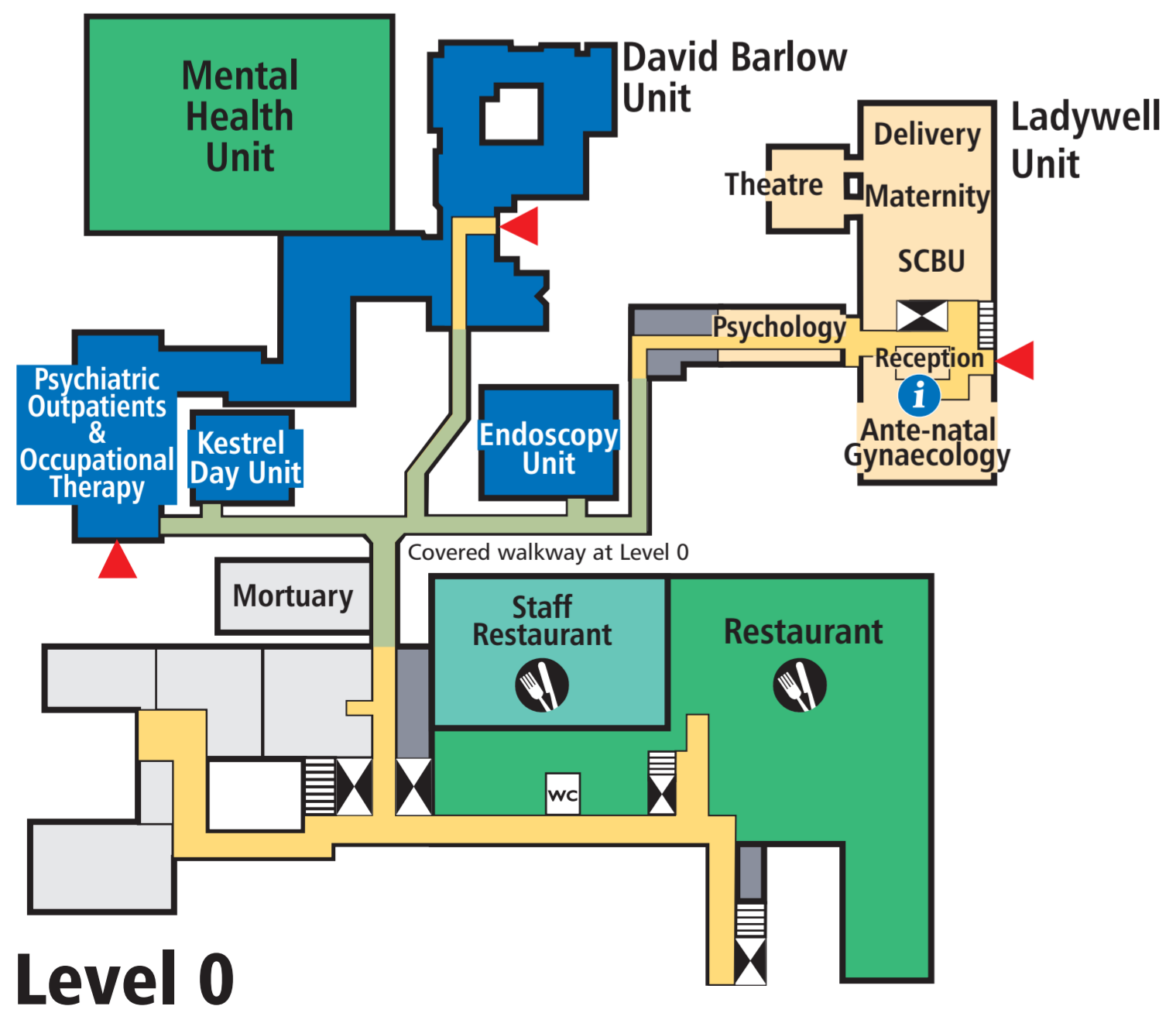
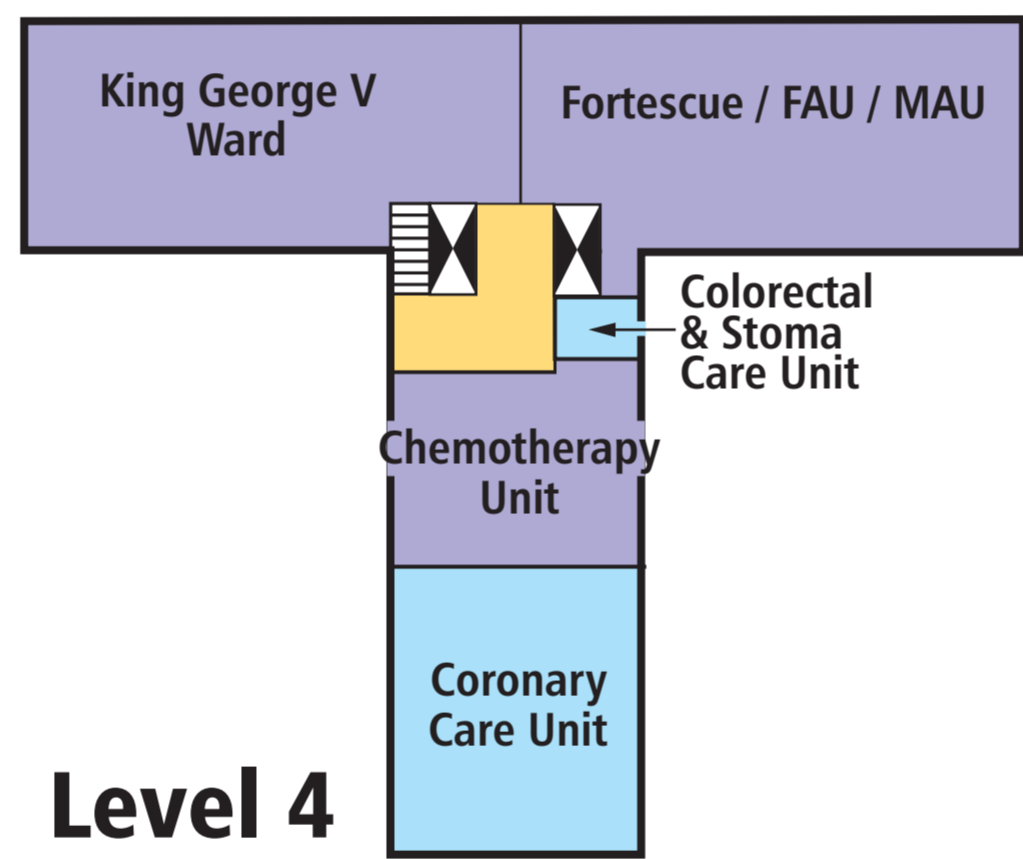
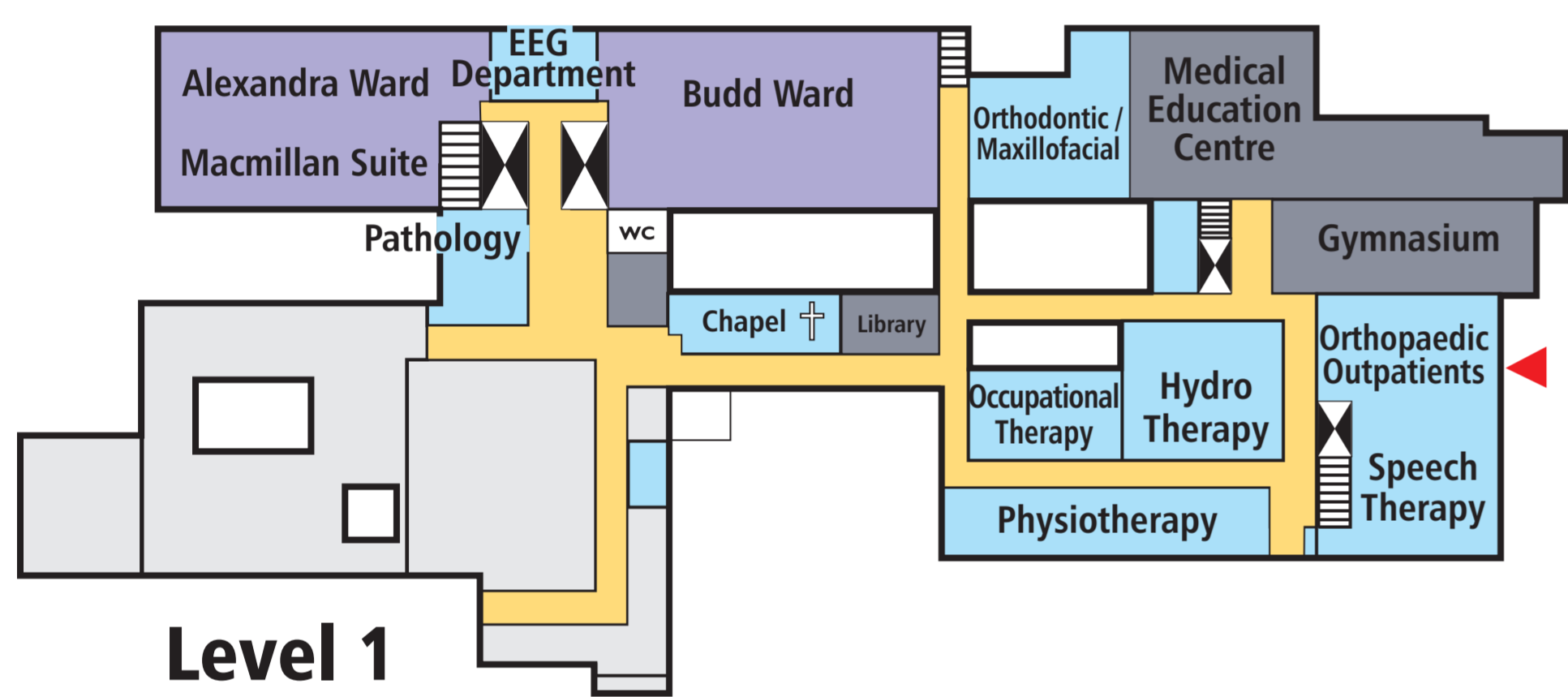
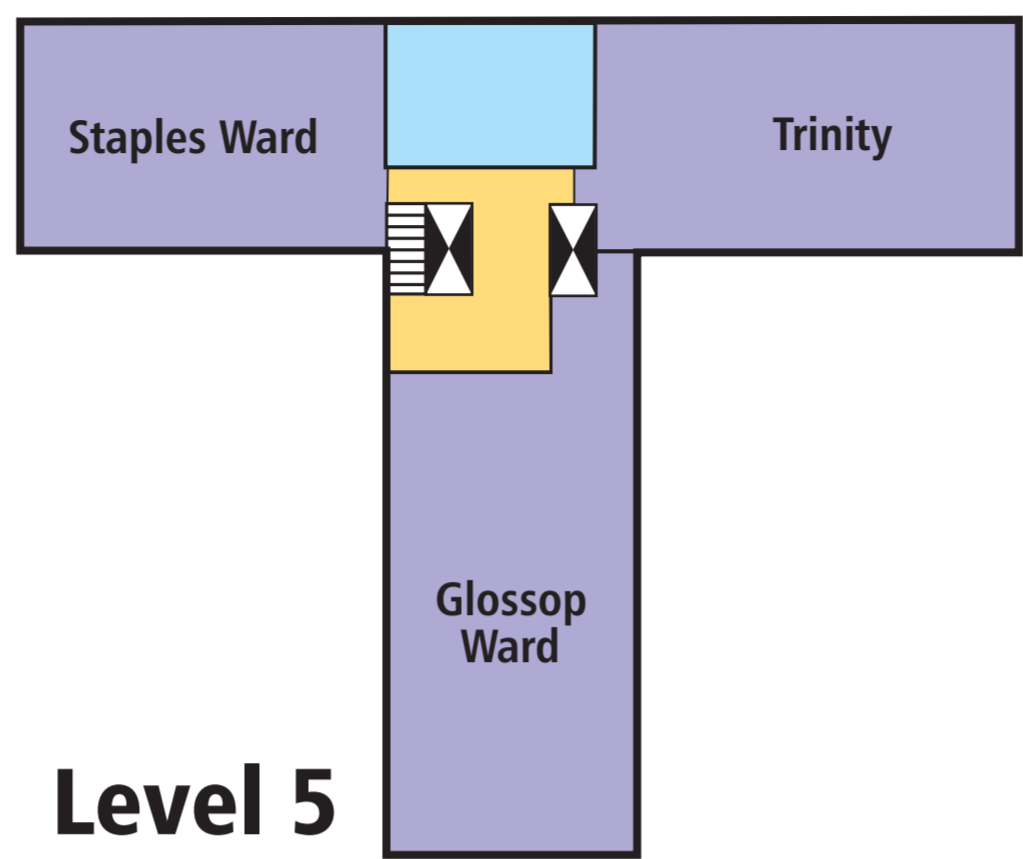
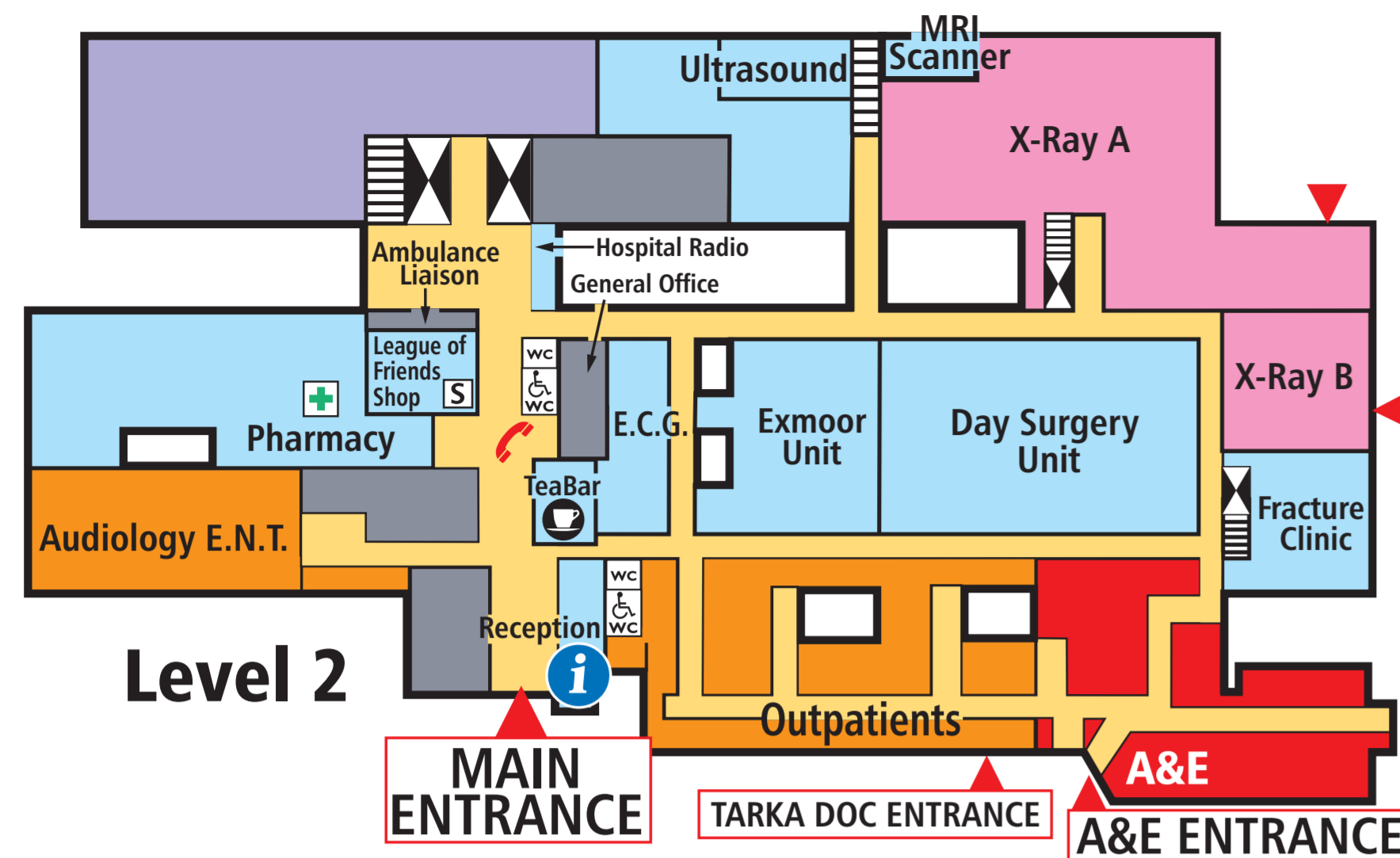

DEPARTMENT	LEVEL	DEPARTMENT	LEVEL
Main Hospital			
Accident & Emergency	2	Lundy Ward	3
Alexandra Ward	1	Macmillan Suite (Alex)	1
Ambulance Liaison	2	Main Entrance	2
Audiology ENT	2	Main Theatre Suite	3
Budd Ward	1	Medical Education Centre	1
Capener Ward	3	Mortuary	0
Caroline Thorpe Ward	3	MRI Scanner	2
Chapel	1	Occupational Therapy	1
Chemotherapy Unit	4	Orthodontic/Maxillofacial Dept	1
Colorectal & Stoma Care Unit	4	Orthopaedic Outpatients	1
Coronary Care Unit	4	Outpatients (General)	2
Day Surgery Unit	2	Paediatric Outpatients	3
ECG	2	Pathology	1
EEG Department	1	Pharmacy	2
Exmoor Unit	2	Physiotherapy	1
Eye Department	2	Reception	2
Fortescue FAU/MAU	4	Restaurant (Raleigh Galley)	0
Fracture Clinic	2	Roborough Suite	3
General Office	2	Shop (League of Friends)	2
Glossop Ward	5	Speech Therapy	1
Hospital Radio (Tarka Radio)	2	Staples Ward	5
Hydrotherapy	1	Tarka Doc	2
Intensive Care Unit	3	Tea Bar (League of Friends)	2
King George V Ward	4	Trinity	5
Library	1	X-Ray Departments (A&B)	2

DEPARTMENT	LEVEL	DEPARTMENT	LEVEL
Ladywell Unit			
Ante-Natal	0	David Barlow & Linked Units	
Bassett Ward	1	David Barlow Unit	0
Breast Care Unit	2	Endoscopy	0
Delivery Unit	0	Kestrel Day Unit	0
Gynaecology	0	Mental Health Unit	0
Petter Ward	2	Psychiatric Outpatients & Occupational Therapy	0
Psychology	0		
Special Care Baby Unit (SCBU)	0		

Legend:

- i** INFORMATION
- LINK CORRIDORS**
- ENTRANCES**
- PUBLIC TELEPHONE**
- LIFTS**
- STAIRS**
- WC MALE & FEMALE**
- WC DISABLED WC**
- RESTAURANT**
- TEA / COFFEE**
- SHOP**
- PHARMACY**
- COVERED WALKWAY**

© COPYRIGHT
PREMIER CONCEPTS
health media
Tel: 01666 829003

DISCLAIMER
The products and services advertised herein should not be regarded as carrying the hospital authority's recommendation.